



## Safety Guiding Principles

We value human life and well-being above all else and take action accordingly.

All incidents, injuries, and workplace illnesses are preventable.

We are personally accountable for our own and collectively responsible for each other's safety.

By committing to safety first, we advance our goals for quality, cost, and schedule.

# Visitor Safety Guide

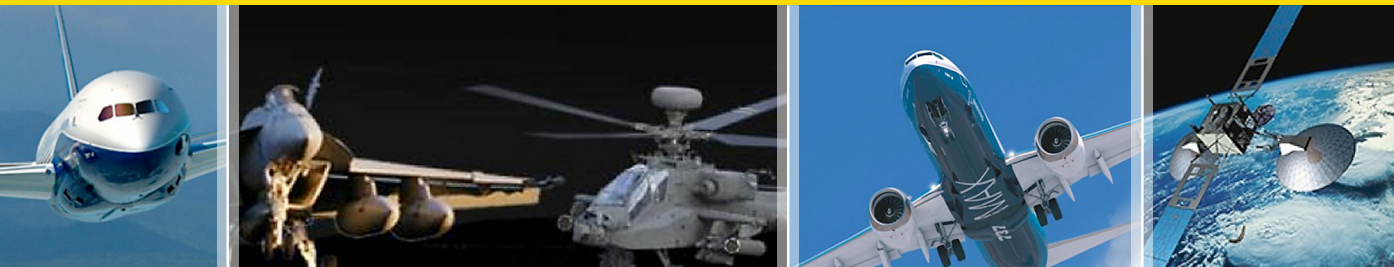

It's personal—for you and for us.

Visitor

Host

# Santa Susana



One Day at a Time.

## Welcome to Boeing

At Boeing, safety is a core value. We are committed to creating a safe, zero-injury environment for our employees and for visitors to our facilities. This aligns with the proud Boeing tradition of designing and building safe products for our customers.

We want your visit to be safe.

Please take time to review the safety practices covered in this brochure. Your host will assist you in understanding them.

Some of the practices are common sense, such as using handrails on stairs. Others—such as using cell phones only when standing still—may be new to you. They all have one thing in common—they're for your safety and the safety of those around you.

Thank you for your cooperation to make this an injury-free workplace.

We hope you have a pleasant—and safe—visit.

# Safety Requirements



## ELECTRONIC DEVICES

Stand still and be aware of your surroundings.

Use only in a Safety Zone.

Go hands-free when walking, driving, or biking.



## EYE AND EAR SAFETY

Protect your eyes and hearing in production, factory, or operations areas.



## PARKING LOTS / INTERSECTIONS

Use crosswalks and walkways.

Look both ways.

Make yourself visible to vehicles, and make eye contact with drivers.



## SAFETY LINES

Stay on crosswalks and walkways.

Observe and obey posted signs.

Be aware of vehicles, cranes, moving equipment, and other potential hazards around you.



## STAIRWAYS

Use handrails on stairways.

Take one step at a time.



## OFFICE AISLEWAYS

Be aware, slow down, and look around at intersections.



## PROTECTIVE FOOTWEAR

Always wear appropriate footwear.



## YELLOW REFLECTIVE VESTS

Stay visible and observe flight lines and ramp area safety precautions provided by your host.

## Evacuation Route

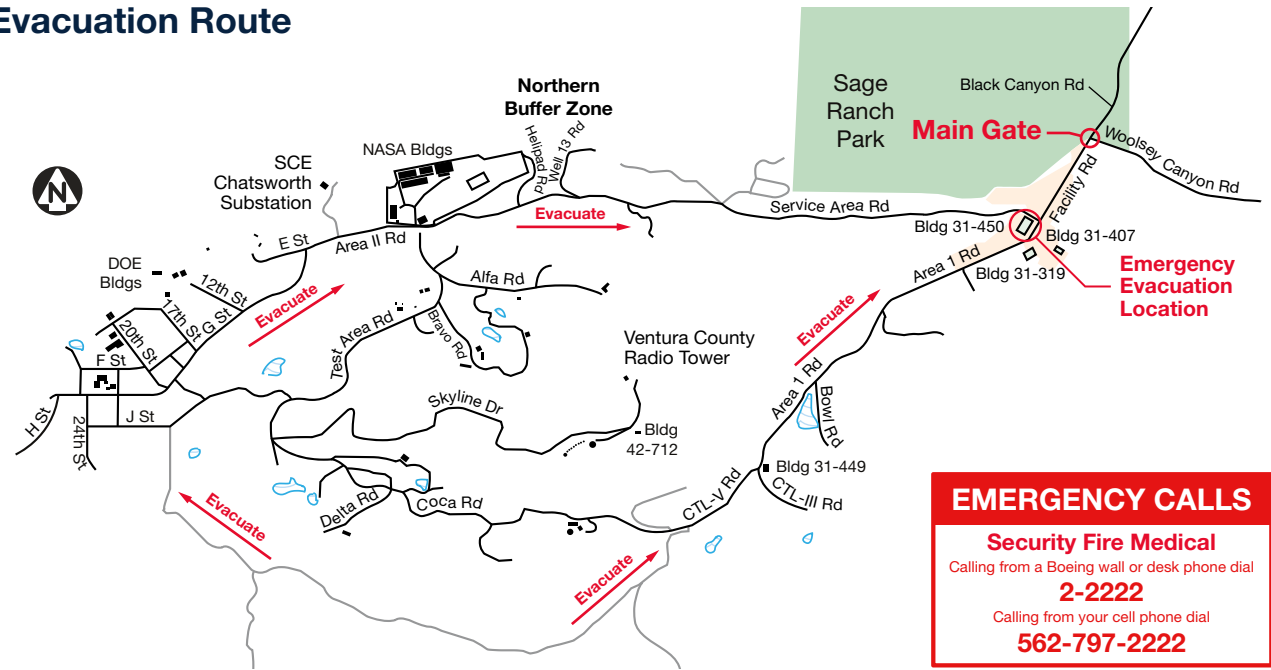

## Santa Susana Site Requirements

1. Report emergencies by desk phone, two-way radio, or through a Boeing site representative. Cell phone coverage is limited.
2. Extreme fire conditions are common in the dry season. Absolutely no smoking or open flame is allowed. Do not drive or park on tall grass or brush. If you see or smell smoke, report it and go directly to the emergency evacuation area.
3. Read and obey all signs. Stay out of restricted areas, unless authorized.
4. Drive carefully and obey traffic signs and speed limits. Steep, narrow dirt roads and blind corners exist. Slow-moving vehicles and heavy equipment are common and 4-wheel drive is required in some areas.
5. Beware of abundant wildlife, such as rattlesnakes, mountain lions, coyotes, bees, ticks, and spiders. Use insect repellent if you are particularly sensitive to insect bites. Certain visitors who enter brush areas will be provided with snake gaiters.
6. Poisonous plants are prevalent. Avoid poison oak and stinging nettle.
7. Extreme environmental conditions may exist.
  - ✓ **Extreme temperatures. Stay hydrated and carry water with you when hiking.**
  - ✓ **High winds. Be mindful of blowing dust and debris.**
  - ✓ **Lightning. Take shelter when lightning threatens.**
  - ✓ **Sun exposure. Use hats, clothing, and sunscreen to protect yourself.**
8. Uneven ground and tripping hazards are common away from the office areas. Watch your step and wear flat soled shoes. Flip-flops or open-toed sandals are not allowed.
9. Don't get lost. Stay with your escort and on the path or road. Know your location if unescorted.
10. Portions of the site are administered by NASA and DOE and are indicated by signage. Your permitted presence on Boeing, NASA, or DOE property is conditional and is based on your good behavior and following these simple rules.
11. Stay safe and enjoy your visit to Santa Susana.

## General site requirements

Officially issued credentials/badges must be visible at all times.

Use of tobacco on company property is prohibited.

## In the event of an emergency

- Follow your host—or other Boeing personnel—to a safe location.
- Ask your host to get help if in need of first aid.